

TORQUE TOOL SPECIALIST



1-484-951-6628



T SERIES TOOLING

BOLTING PROBLEM SOLVERS SINCE 2004

TEL : 1-484-951-6628

SALES : BOLTING@NIBTORQUE.COM

FAX : 1-866-780-9316

WEB : WWW.NIBTORQUE.COM

T SERIES

TORQUE WRENCHES

18 MONTH WARRANTY



MADE IN THE U.S.A. FROM AIRCRAFT GRADE T6 7075 ALUMINUM

MODEL NUMBER	Units	T1	T3	T5	T8	T10	T25	T50
Square Drive Size	(In)	3/4	1	1-1/2	1-1/2	1-1/2	2-1/2	2-1/2
Optional Square Drive Sizes	(In)	1/2 & 1	3/4 & 1 1/2	1 & 2 1/2	1 & 2 1/2	1 & 2 1/2	1 1/2 & 3 1/2	3-1/2
Range Optional Hex Drive Sizes (Other sizes and special drives are available upon request)	(In)	3/8 to 1	5/8 to 1 1/4	1 to 1 1/2	1 1/8 to 1 3/4	1 1/4 to 2	1 5/8 to 2 1/4	1 5/8 to 2 3/4
	(mm)	9 to 26	16 to 32	26 to 38	28 to 45	32 to 51	41 to 57	41 to 70
Torque Range	(Ft-Lb)	197 to 1359	468 to 3124	816 to 5605	1168 to 8062	1662 to 11067	3726 to 24749	8274 to 54176
	(N-M)	267 to 1843	635 to 4236	1107 to 7601	1584 to 10932	2254 to 15007	5052 to 33560	11220 to 73463
Weight: Includes Reaction Arm	(Lb)	5.0	10.0	17.0	25.0	30.0	70.0	115.0
	(Kg)	2.27	4.54	7.71	11.34	13.61	31.75	52.15

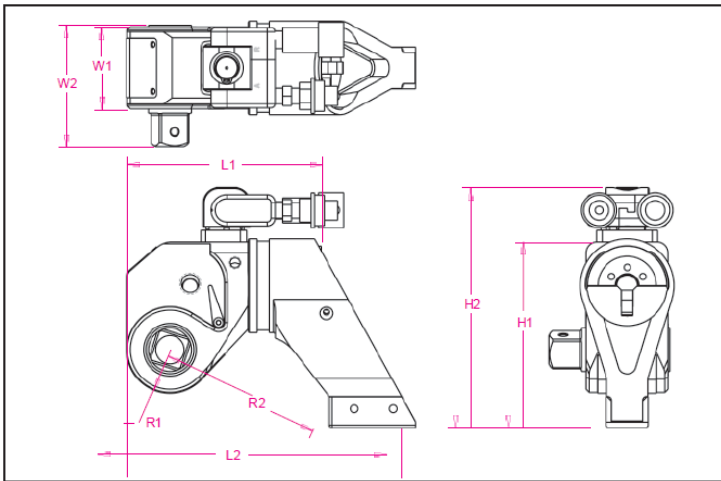

	DIMENSIONS							
L1 - Body Length	(In)	4.81	6.29	7.10	7.70	8.80	11.80	14.75
	(mm)	122.2	159.8	180.3	195.6	223.5	299.7	374.7
L2 - Overall Length: Includes Arm	(In)	6.95	9.59	11.22	12.57	13.89	18.52	21.50
	(mm)	176.5	243.6	285.0	319.3	352.8	470.4	546.1
H1 - Tool Height	(In)	3.63	4.93	5.75	6.50	7.84	9.60	15.00
	(mm)	92.2	125.2	146.1	165.1	199.1	243.8	381.0
H2 - Overall Height: Includes Swivel	(In)	4.95	6.75	7.71	8.49	9.11	11.55	16.80
	(mm)	125.7	171.5	195.8	215.6	231.4	293.4	426.7
W1 - Tool Width	(In)	1.98	2.63	3.15	3.57	3.95	5.25	7.00
	(mm)	50.3	66.8	80.0	90.7	100.3	133.4	177.8
W2 - Tool Width: Includes Sq. Drive	(In)	2.83	3.89	4.65	5.09	5.61	7.48	9.25
	(mm)	71.9	98.8	118.1	129.3	142.5	190.0	235.0
R1 - Tool Radius around the Bolt	(In)	0.98	1.13	1.56	1.76	1.95	2.60	3.00
	(mm)	24.9	28.7	39.6	44.7	49.5	66.0	76.2
R2 - Reaction Reach	(In)	3.85	5.33	6.15	6.96	7.69	11.30	12.50
	(mm)	97.8	135.4	156.2	176.8	195.3	287.0	317.5

